

# PULEGGE DENTATE TIPO HTD - FORO CONICO PER BUSSOLA TAPER LOCK PASSO 8mm PER CINGHIA LARGA 30mm

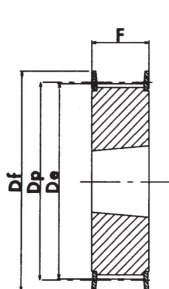

esecuzione 1F

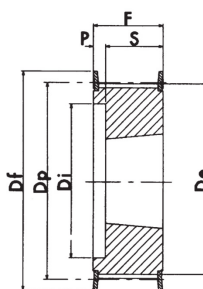

esecuzione 2F

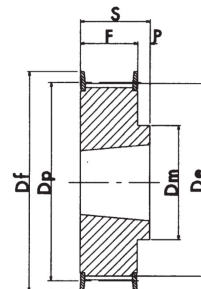

esecuzione 5F

Materiale  
AC = ACCIAIO  
GH = GHISA

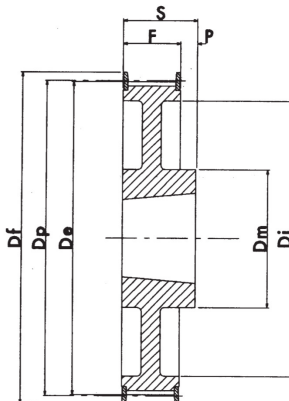

esecuzione 6F

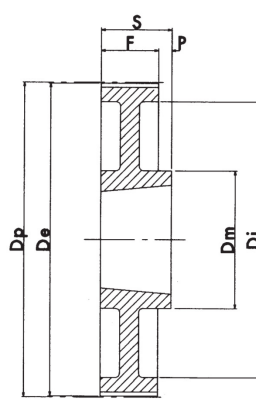

esecuzione 7

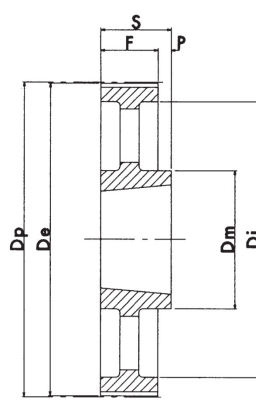

esecuzione 8

N°Denti	Bussola	FORO MAX mm	Esecuzione	Flangia	Dp mm	De mm	Df mm	Dm mm	Di mm	F mm	S mm	P mm	Materiale	Codice
22	1008	25	2F	✓	56.02	54.65	60	-	37	38	22	16	AC	228M30FTL
24	1108	25	2F	✓	61.12	59.75	66	-	44	38	22	16	AC	248M30FTL
26	1108	25	2F	✓	66.21	64.85	70	-	44	38	22	16	AC	268M30FTL
28	1210	32	2F	✓	71.30	70.08	75	-	50	38	25	13	AC	288M30FTL
30	1615	42	1F	✓	76.39	75.13	82.5	-	-	38	38	-	AC	308M30FTL
32	1615	42	1F	✓	81.49	80.16	87	-	-	38	38	-	AC	328M30FTL
34	1615	42	1F	✓	86.58	85.22	91	-	-	38	38	-	AC	348M30FTL
36	1615	42	1F	✓	91.67	90.30	97	-	-	38	38	-	AC	368M30FTL
38	1615	42	1F	✓	96.77	95.39	102	-	-	38	38	-	AC	388M30FTL
40	1615	42	1F	✓	101.86	100.49	106	-	-	38	38	-	AC	408M30FTL
44	2012	50	2F	✓	112.05	110.67	120	-	86	38	32	6	AC	448M30FTL
48	2012	50	2F	✓	122.23	120.86	128	-	90	38	32	6	AC	488M30FTL
56	2012	50	2F	✓	142.60	141.23	150	-	110	38	32	6	AC	568M30FTL
64	2517	60	5F	✓	162.97	161.60	168	125	-	38	45	7	AC	648M30FTL
72	2517	60	6F	✓	183.35	181.97	192	125	158	38	45	7	AC	728M30FTL
80	2517	60	7		203.72	202.35	-	125	180	38	45	7	GH	808M30TL
90	2517	60	7		229.18	227.81	-	125	204	38	45	7	GH	908M30TL
112	2517	60	7		285.21	283.83	-	125	254	38	45	7	GH	1128M30TL
144	2517	60	8		366.69	365.32	-	125	336	38	45	7	GH	1448M30TL

