

PULEGGE DENTATE TIPO HTD - MOZZO GREZZO

PASSO 5mm PER CINGHIA LARGA 15mm

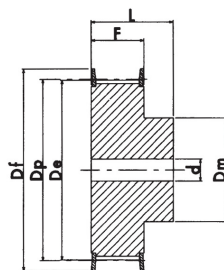

esecuzione 1F

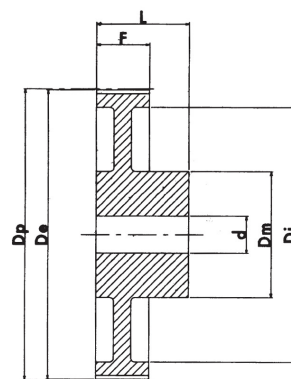

esecuzione 3

Materiale

AC = ACCIAIO

AL = ALLUMINIO

GH = GHISA

| N°Denti | Esecuzione | Flangia | Dp mm | De mm | Df mm | Dm mm | Di mm | F mm | L mm | d mm | Materiale | Codice |
|---------|------------|---------|----------|----------|----------|----------|----------|---------|---------|---------|-----------|---------|
| 12 | 1F | ✓ | 19.10 | 17.96 | 23.0 | 13.0 | - | 20.5 | 26.0 | - | AC | 125M15F |
| 14 | 1F | ✓ | 22.28 | 21.14 | 25.0 | 13.0 | - | 20.5 | 26.0 | 6.0 | AC | 145M15F |
| 15 | 1F | ✓ | 23.87 | 22.73 | 28.0 | 16.0 | - | 20.5 | 26.0 | 6.0 | AC | 155M15F |
| 16 | 1F | ✓ | 25.46 | 24.32 | 28.0 | 16.5 | - | 20.5 | 26.0 | 6.0 | AC | 165M15F |
| 18 | 1F | ✓ | 28.65 | 27.51 | 32.0 | 20.0 | - | 20.5 | 26.0 | 6.0 | AC | 185M15F |
| 20 | 1F | ✓ | 31.83 | 30.69 | 36.0 | 23.0 | - | 20.5 | 26.0 | 6.0 | AC | 205M15F |
| 21 | 1F | ✓ | 33.42 | 32.28 | 38.0 | 24.0 | - | 20.5 | 26.0 | 6.0 | AC | 215M15F |
| 22 | 1F | ✓ | 35.01 | 33.87 | 39.0 | 25.5 | - | 20.5 | 26.0 | 6.0 | AC | 225M15F |
| 24 | 1F | ✓ | 38.20 | 37.06 | 42.0 | 27.0 | - | 20.5 | 28.0 | 6.0 | AC | 245M15F |
| 26 | 1F | ✓ | 41.38 | 40.24 | 44.0 | 30.0 | - | 20.5 | 28.0 | 6.0 | AC | 265M15F |
| 28 | 1F | ✓ | 44.56 | 43.42 | 48.0 | 30.5 | - | 20.5 | 28.0 | 6.0 | AC | 285M15F |
| 30 | 1F | ✓ | 47.75 | 46.60 | 51.0 | 35.0 | - | 20.5 | 28.0 | 6.0 | AC | 305M15F |
| 32 | 1F | ✓ | 50.93 | 49.79 | 54.0 | 38.0 | - | 20.5 | 28.0 | 8.0 | AC | 325M15F |
| 36 | 1F | ✓ | 57.30 | 56.16 | 60.0 | 38.0 | - | 20.5 | 28.0 | 8.0 | AC | 365M15F |
| 40 | 1F | ✓ | 63.66 | 62.52 | 71.0 | 38.0 | - | 20.5 | 28.0 | 8.0 | AC | 405M15F |
| 44 | 3 | | 70.03 | 68.89 | - | 38.0 | 54 | 20.5 | 30.0 | 8.0 | AL | 445M15 |
| 48 | 3 | | 76.39 | 75.25 | - | 38.0 | 61 | 20.5 | 30.0 | 8.0 | AL | 485M15 |
| 60 | 3 | | 95.49 | 94.35 | - | 50.0 | 80 | 20.5 | 30.0 | 8.0 | AL | 605M15 |
| 72 | 3 | | 114.59 | 113.45 | - | 50.0 | 100 | 20.5 | 30.0 | 8.0 | AL | 725M15 |

