

# PULEGGE DENTATE TIPO HTD - MOZZO GREZZO

## PASSO 5mm PER CINGHIA LARGA 9mm

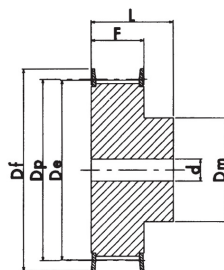

esecuzione 1F

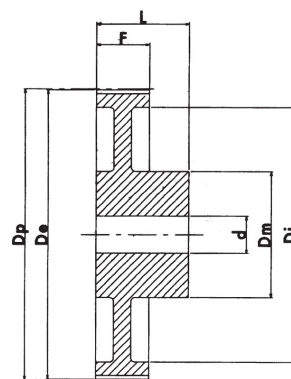

esecuzione 3

Materiale

AC = ACCIAIO

AL = ALLUMINIO

GH = GHISA

N°Denti	Esecuzione	Flangia	Dp mm	De mm	Df mm	Dm mm	Di mm	F mm	L mm	d mm	Materiale	Codice
12	1F	✓	19.10	17.96	23.0	13.0	-	14.5	20.0	4.0	AC	125M09F
14	1F	✓	22.28	21.14	25.0	13.0	-	14.5	20.0	6.0	AC	145M09F
15	1F	✓	23.87	22.73	28.0	16.0	-	14.5	20.0	6.0	AC	155M09F
16	1F	✓	25.46	24.32	28.0	16.5	-	14.5	20.0	6.0	AC	165M09F
18	1F	✓	28.65	27.51	32.0	20.0	-	14.5	20.0	6.0	AC	185M09F
20	1F	✓	31.83	30.69	36.0	23.0	-	14.5	22.5	6.0	AC	205M09F
21	1F	✓	33.42	32.28	38.0	24.0	-	14.5	22.5	6.0	AC	215M09F
22	1F	✓	35.01	33.87	39.0	25.5	-	14.5	22.5	6.0	AC	225M09F
24	1F	✓	38.20	37.06	42.0	27.0	-	14.5	22.5	6.0	AC	245M09F
26	1F	✓	41.38	40.24	44.0	30.0	-	14.5	22.5	6.0	AC	265M09F
28	1F	✓	44.56	43.42	48.0	30.5	-	14.5	22.5	6.0	AC	285M09F
30	1F	✓	47.75	46.60	51.0	35.0	-	14.5	22.5	6.0	AC	305M09F
32	1F	✓	50.93	49.79	54.0	38.0	-	14.5	22.5	8.0	AC	325M09F
36	1F	✓	57.30	56.16	60.0	38.0	-	14.5	22.5	8.0	AC	365M09F
40	1F	✓	63.66	62.52	71.0	38.0	-	14.5	22.5	8.0	AC	405M09F
44	3		70.03	68.89	-	38.0	54	14.5	25.5	8.0	AL	445M09
48	3		76.39	75.25	-	45.0	61	14.5	25.5	8.0	AL	485M09
60	3		95.49	94.35	-	45.0	80	14.5	25.5	8.0	AL	605M09
72	3		114.59	113.45	-	45.0	100	14.5	25.5	8.0	AL	725M09

