

# BARRE DENTATE PER CINGHIE POSITIVE IN POLLICI

## PASSO L (3/8", 9.52mm)

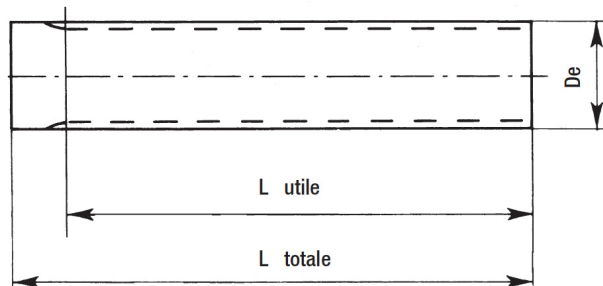
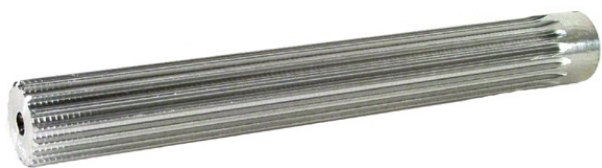

Materiale:

AC = ACCIAIO

AL = ALLUMINIO

N°Denti	De	L Utile	L Tot	Materiale	Codice
	mm	mm	mm		
10	29.56	140	140	AL	L10AL
10	29.56	140	140	AC	L10AC
11	32.59	140	140	AL	L11AL
11	32.59	140	140	AC	L11AC
12	35.62	160	160	AL	L12AL
12	35.62	160	160	AC	L12AC
13	38.65	160	160	AL	L13AL
13	38.65	160	160	AC	L13AC
14	41.68	160	160	AL	L14AL
14	41.68	160	160	AC	L14AC
15	44.72	160	160	AL	L15AL
15	44.72	160	160	AC	L15AC
16	47.75	160	160	AL	L16AL
16	47.75	160	160	AC	L16AC
17	50.78	160	160	AL	L17AL
17	50.78	160	160	AC	L17AC
18	53.81	160	160	AL	L18AL
18	53.81	160	160	AC	L18AC
19	56.84	160	160	AL	L19AL
19	56.84	160	160	AC	L19AC
20	59.88	160	160	AL	L20AL
20	59.88	160	160	AC	L20AC
21	62.91	160	160	AL	L21AL
21	62.91	160	160	AC	L21AC
22	65.94	160	160	AL	L22AL
22	65.94	160	160	AC	L22AC
23	68.97	160	160	AL	L23AL
23	68.97	160	160	AC	L23AC
24	72.00	160	160	AL	L24AL
24	72.00	160	160	AC	L24AC
27	81.10	160	160	AL	L27AL
27	81.10	160	160	AC	L27AC
30	90.20	160	160	AL	L30AL
30	90.20	160	160	AC	L30AC

