

# BARRE DENTATE PER CINGHIE POSITIVE IN POLLICI

## PASSO XL (1/5", 5.08mm)

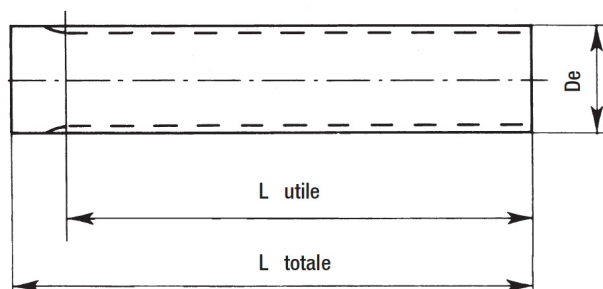
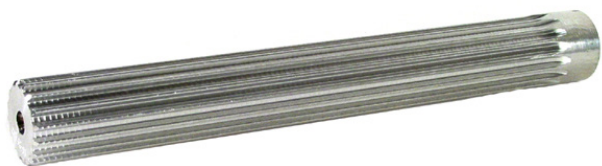

### Materiale

AC = ACCIAIO

AL = ALLUMINIO

N°Denti	De	L Utile	L Tot	Materiale	Codice
	mm				
10	15.66	125	140	AL	XL10AL
10	15.66	125	140	AC	XL10AC
11	17.28	125	140	AL	XL11AL
11	17.28	125	140	AC	XL11AC
12	18.90	125	140	AL	XL12AL
12	18.90	125	140	AC	XL12AC
13	20.51	125	140	AL	XL13AL
13	20.51	125	140	AC	XL13AC
14	22.13	132	140	AL	XL14AL
14	22.13	132	140	AC	XL14AC
15	23.75	132	140	AL	XL15AL
15	23.75	132	140	AC	XL15AC
16	25.36	140	140	AL	XL16AL
16	25.36	140	140	AC	XL16AC
17	26.98	140	140	AL	XL17AL
17	26.98	140	140	AC	XL17AC
18	28.60	140	140	AL	XL18AL
18	28.60	140	140	AC	XL18AC
19	30.22	140	140	AL	XL19AL
19	30.22	140	140	AC	XL19AC
20	31.83	140	140	AL	XL20AL
20	31.83	140	140	AC	XL20AC
21	33.45	160	160	AL	XL21AL
21	33.45	160	160	AC	XL21AC
22	35.07	160	160	AL	XL22AL
22	35.07	160	160	AC	XL22AC
23	36.60	160	160	AL	XL23AL
23	36.60	160	160	AC	XL23AC
24	38.30	160	160	AL	XL24AL
24	38.30	160	160	AC	XL24AC



**BARRE DENTATE PER CINGHIE POSITIVE IN POLLICI**  
PASSO XL (1/5", 5.08mm)

N°Denti	De	L Utile	L Tot	Materiale	Codice
	mm	mm	mm		
25	39.93	160	160	AL	XL25AL
25	39.93	160	160	AC	XL25AC
26	41.53	160	160	AL	XL26AL
26	41.53	160	160	AC	XL26AC
27	43.15	160	160	AL	XL27AL
27	43.15	160	160	AC	XL27AC
28	44.77	160	160	AL	XL28AL
28	44.77	160	160	AC	XL28AC
29	46.39	160	160	AL	XL29AL
29	46.39	160	160	AC	XL29AC
30	48.00	160	160	AL	XL30AL
30	48.00	160	160	AC	XL30AC
32	51.24	160	160	AL	XL32AL
32	51.24	160	160	AC	XL32AC
33	52.76	160	160	AL	XL33AL
33	52.76	160	160	AC	XL33AC
34	54.47	160	160	AL	XL34AL
34	54.47	160	160	AC	XL34AC
35	56.09	160	160	AL	XL35AL
35	56.09	160	160	AC	XL35AC
36	57.70	160	160	AL	XL36AL
36	57.70	160	160	AC	XL36AC
38	60.94	160	160	AL	XL38AL
38	60.94	160	160	AC	XL38AC
39	52.56	160	160	AL	XL39AL
39	52.56	160	160	AC	XL39AC
40	64.17	160	160	AL	XL40AL
40	64.17	160	160	AC	XL40AC
41	65.79	160	160	AL	XL41AL
41	65.79	160	160	AC	XL41AC
42	67.41	160	160	AL	XL42AL
42	67.41	160	160	AC	XL42AC
43	69.02	160	160	AL	XL43AL
43	69.02	160	160	AC	XL43AC
44	70.64	160	160	AL	XL44AL
44	70.64	160	160	AC	XL44AC
48	77.11	160	160	AL	XL48AL
48	77.11	160	160	AC	XL48AC
56	90.04	160	160	AL	XL56AL
56	90.04	160	160	AC	XL56AC
60	96.51	160	160	AL	XL60AL
60	96.51	160	160	AC	XL60AC
72	115.92	160	160	AL	XL72AL
72	115.92	160	160	AC	XL72AC

